

SMD Power Inductor CDRH104R

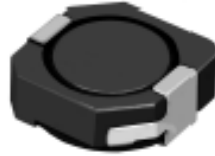

Halogen Free



Description

- Ferrite drum core construction.
- Magnetically shielded.
- L × W × H: 10.5 × 10.3 × 4.0mm Max.
- Product weight: 1.5g(Ref.)
- Moisture Sensitivity Level: 1
- RoHS compliance.
- Halogen Free available.

Environmental Data

- Operating temperature range: -40°C ~ +100°C (including coil's self temperature rise)
- Storage temperature range: -40°C ~ +100°C
- Solder reflow temperature: 260 °C peak.

Packaging

- Carrier tape and reel packaging.
- 12.9" diameter reel.
- 1000pcs per reel.

Applications

- Ideally used in Notebook PC, LCD TV, DVD, Game machine, STB, Projector etc as DC-DC converter inductors.

Dimension - [mm]

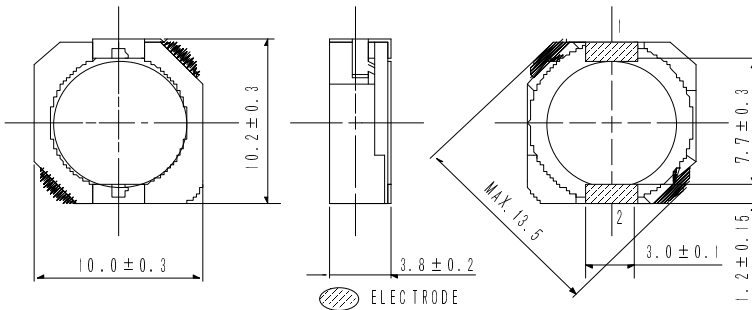

Land pattern and Schematics - [mm]

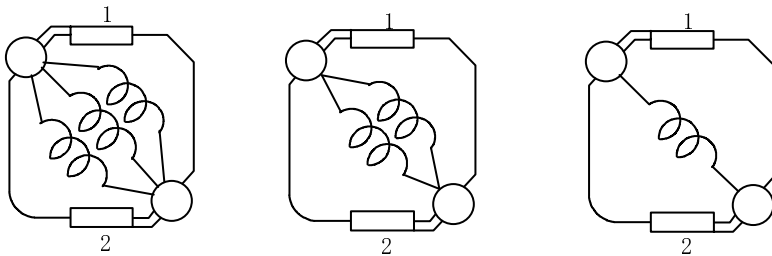
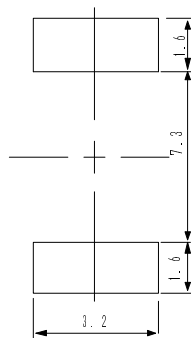

(1.5 μH ~ 5.2 μH, 10 μH) (7.0 μH, 12 μH ~ 33 μH) (39 μH ~ 330 μH)

SMD Power Inductor CDRH104R



Electrical Characteristics

| Part Name | Stamp | Inductance (μ H) [within] ※1 | D.C.R. (m Ω) Max. (Typ.) (at 20°C) | Saturation Current (A) ※2 | Temperature Rise Current (A) ※3 |
|------------------|-------|---|--|---------------------------------|---------------------------------------|
| CDRH104RNP-1R5NC | 1R5 | 1.5 \pm 30% | 8.1 (6.0) | 10.0 | 6.50 |
| CDRH104RNP-2R5NC | 2R5 | 2.5 \pm 30% | 10.5 (7.8) | 7.50 | 6.10 |
| CDRH104RNP-3R8NC | 3R8 | 3.8 \pm 30% | 13.0 (9.6) | 6.00 | 5.50 |
| CDRH104RNP-5R2NC | 5R2 | 5.2 \pm 30% | 22 (16) | 5.50 | 5.40 |
| CDRH104RNP-7R0NC | 7R0 | 7.0 \pm 30% | 27 (20) | 4.80 | 4.50 |
| CDRH104RNP-100NC | 100 | 10 \pm 30% | 35 (26) | 4.40 | 3.80 |
| CDRH104RNP-120NC | 120 | 12 \pm 30% | 46 (34) | 3.70 | 3.40 |
| CDRH104RNP-150NC | 150 | 15 \pm 30% | 50 (37) | 3.60 | 3.10 |
| CDRH104RNP-180NC | 180 | 18 \pm 30% | 69 (51) | 3.10 | 2.60 |
| CDRH104RNP-220NC | 220 | 22 \pm 30% | 73 (54) | 2.90 | 2.50 |
| CDRH104RNP-270NC | 270 | 27 \pm 30% | 88 (65) | 2.60 | 2.30 |
| CDRH104RNP-330NC | 330 | 33 \pm 30% | 93 (69) | 2.30 | 2.20 |
| CDRH104RNP-390NC | 390 | 39 \pm 30% | 127 (94) | 2.20 | 2.00 |
| CDRH104RNP-470NC | 470 | 47 \pm 30% | 128 (95) | 2.10 | 1.90 |
| CDRH104RNP-560NC | 560 | 56 \pm 30% | 188 (139) | 1.65 | 1.50 |
| CDRH104RNP-680NC | 680 | 68 \pm 30% | 213 (158) | 1.50 | 1.42 |
| CDRH104RNP-820NC | 820 | 82 \pm 30% | 283 (218) | 1.45 | 1.30 |
| CDRH104RNP-101NC | 101 | 100 \pm 30% | 304 (225) | 1.35 | 1.25 |
| CDRH104RNP-121NC | 121 | 120 \pm 30% | 375 (278) | 1.20 | 1.08 |
| CDRH104RNP-151NC | 151 | 150 \pm 30% | 506 (375) | 1.15 | 0.85 |
| CDRH104RNP-181NC | 181 | 180 \pm 30% | 568 (421) | 1.00 | 0.75 |
| CDRH104RNP-221NC | 221 | 220 \pm 30% | 756 (560) | 0.92 | 0.70 |
| CDRH104RNP-271NC | 271 | 270 \pm 30% | 853 (632) | 0.84 | 0.55 |
| CDRH104RNP-331NC | 331 | 330 \pm 30% | 1090 (810) | 0.70 | 0.52 |

※1 Inductance measuring condition: at 100kHz.

※2 The saturation current: This indicates the value of DC current when the inductance decreases to 65% of it's nominal.

※3 The temperature rise: The value of DC current when the temperature rise is $\Delta T=30^{\circ}\text{C}$ ($T_a=20^{\circ}\text{C}$).

SMD Power Inductor CDRH104R



Saturation Current & Temperature Rise Graph

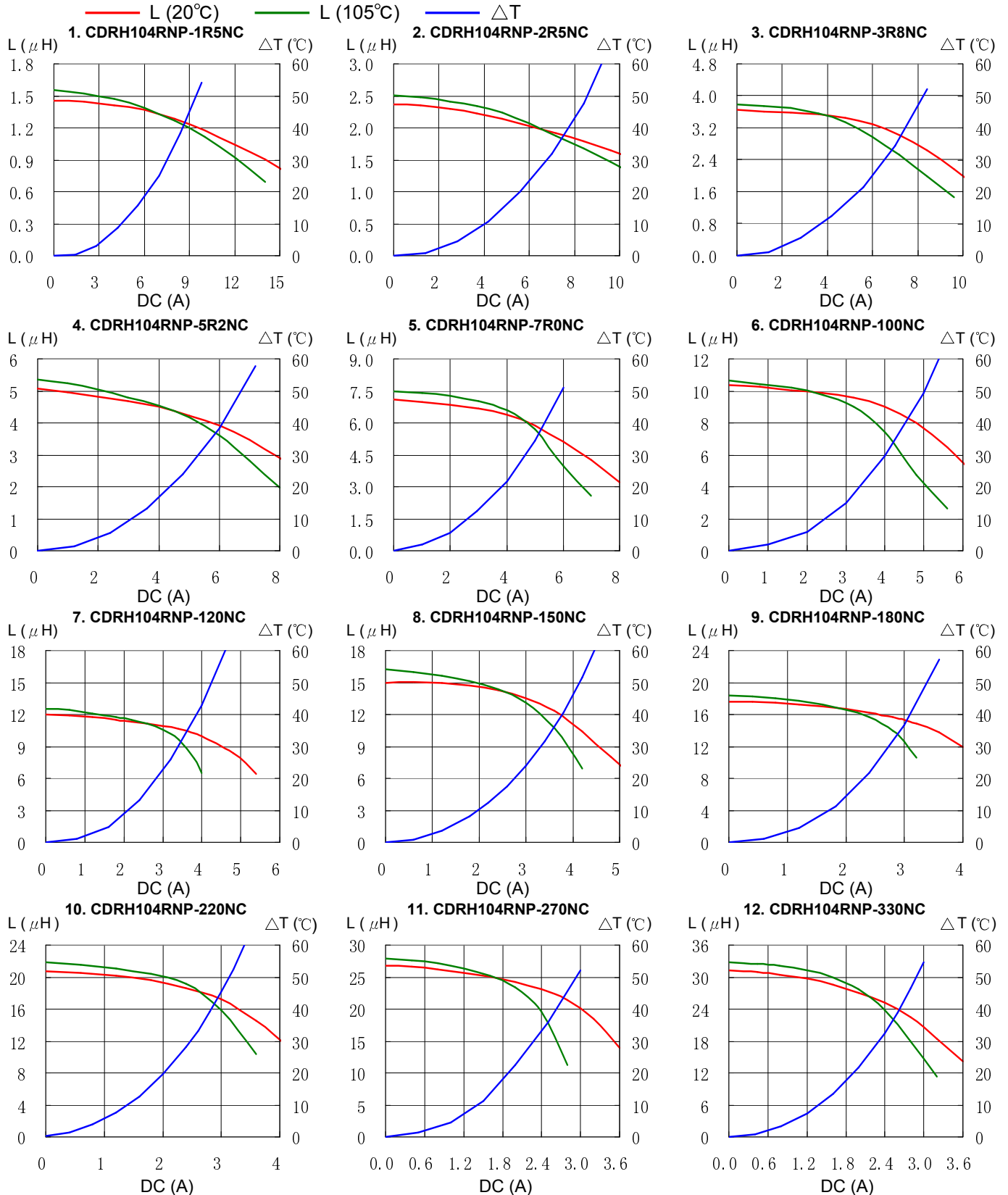

SMD Power Inductor CDRH104R



Saturation Current & Temperature Rise Graph

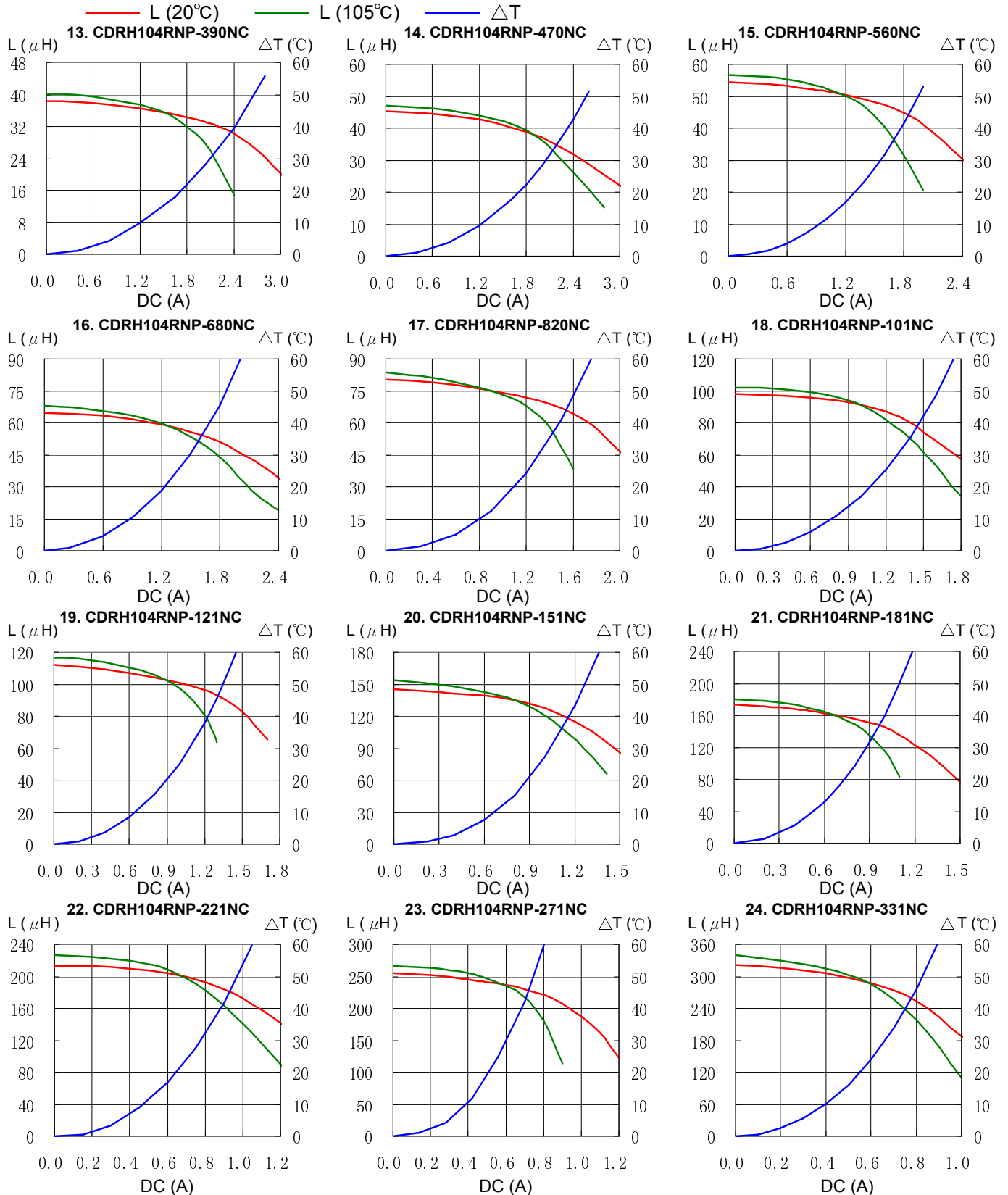

SMD Power Inductor CDRH104R



Solder Reflow Condition

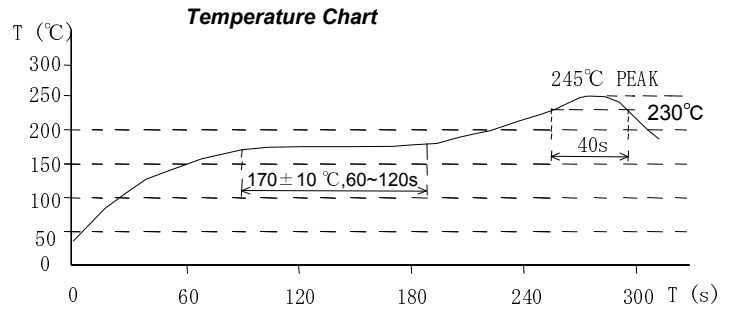
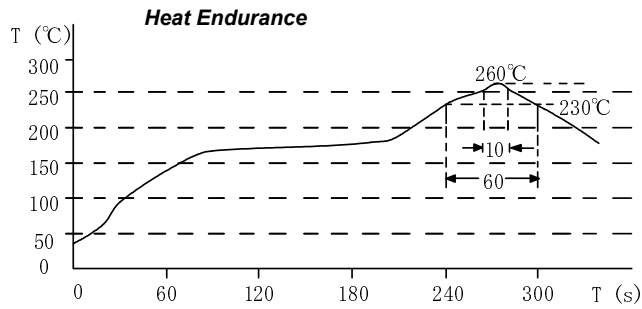

Please refer to the sales offices on our website - <http://www.sumida.com>

Hong Kong

Tel.+852-2880-6781
FAX.+852-2565-9600
sales@hk.sumida.com

Saitama(Japan)

Tel.+81-48-691-7300
FAX.+81-48-691-7340
sales@jp.sumida.com

Chicago

Tel.+1-847-545-6700
FAX. +1-847-545-6720
sales@us.sumida.com

Shanghai

Tel.+86-21-5836-3299
FAX.+86-21-5836-3266
shanghai.sales@cn.sumida.com

Seoul

Tel.+82-2-6237-0777
FAX.+82-2-6237-0778
sales@kr.sumida.com

Oberzell

Tel.+49-8591-937-0
FAX. +49-8591-937-103
contact@eu.sumida.com

Shenzhen

Tel.+86-755-8291-0228
FAX.+86-755-8291-0338
shenzhen.sales@cn.sumida.com

Singapore

Tel.+65-6296-3388
FAX.+65-6841-4426
sales@sg.sumida.com

Neumarkt

Tel.+49-9181-4509-110
FAX. +49-9181-4509-310
infocomp@eu.sumida.com

Taipei

Tel.+886-2-8751-2737
FAX.+886-2-8751-2738
sales@tw.sumida.com

San Jose

Tel.+1-408-321-9660
FAX.+1-408-321-9308
sales@us.sumida.com